

Rev	AWO #	Description	Date	Appr
-		RELEASED	7/09/10	

APPROVED: _____ TITLE: _____
 DATE: _____

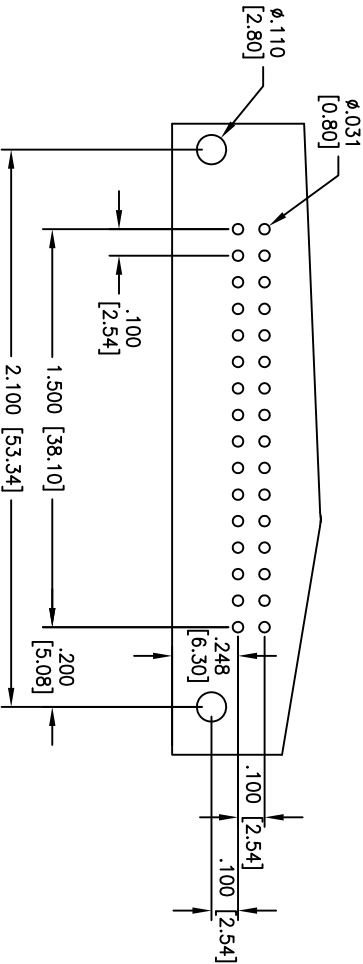

RECOMMENDED PCB LAYOUT

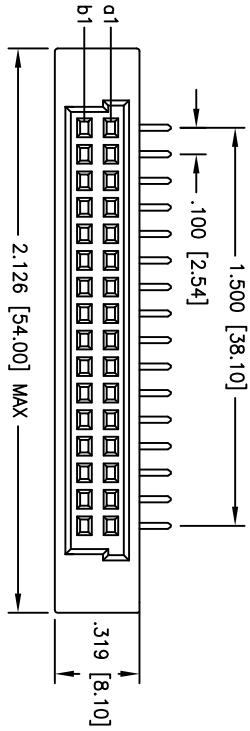
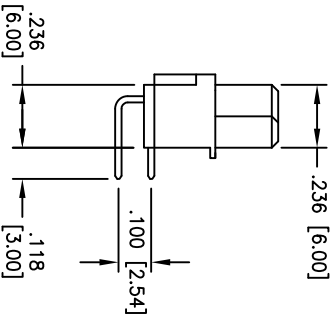
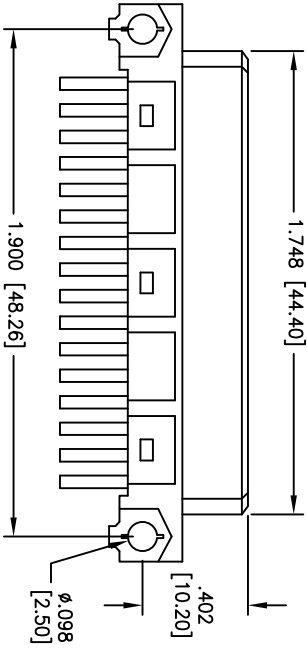

Qty	PLATING
1	30 u" Gold
2	15 u" Gold
3	Gold Flash

SPECIFICATIONS:

Material: Insulator: PBT, glass reinforced, rated UL 94V-0
 Insulator color: Grey
 Contacts: Copper Alloy

Plating: X Gold over Nickel on contact area, Tin over Copper underplate on tails
 (See chart for thickness)

Electrical:
 Current rating: 2 Amps max
 Contact resistance: 30 mohms max
 Insulation resistance: 1000 Mohms min @ 500 VDC
 Dielectric withstanding voltage: 1000 VAC for 1 minute
 Temperature Rating:
 Operating temperature: -55°C to +105°C

Environmental:
 Lead free, RoHS compliant.
 Recommended soldering temp: 235°C for 5 sec.



ADAM TECH

909 Rahway Avenue, Union, NJ 07083
 Phone: 908-687-5000 Fax: 908-687-5710

DIN TYPE HALF Q, 32 POSITIONS, R/A,
 ROW A & B LOADED, PCB MOUNT

UNLESS OTHERWISE SPECIFIED ALL DIMENSIONS ARE MM [INCHES]	
TOLERANCES: EXCEPT AS NOTED	
INCHES	HOLE
.X ± .10	ØXX ± .10
.XX ± .020	ØXXX ± .015
.XXX ± .015	ØXXXX ± .010
APPROVALS	DATE
DRAWN DY	7/09/10
CHECKED	
APPROVED	

REF: S0008T	SCALE: NTS	SHEET 1 OF 1
SIZE PART NO.	DIN-32FR-S22-A1CX	REV. -